

# LAMORINDA'S LEADING INDEPENDENT REAL ESTATE FIRM

## ORINDA

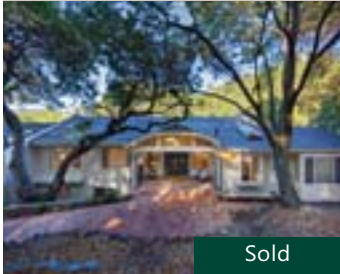

Sold

**8 Charles Hill Circle**  
Large 4320 sqft 6 bed/  
3.5bath Orinda family  
home with separate in-law  
accommodations.  
**\$1,550,000**

## ORINDA



Sold

**19 Donald Drive**  
Serene 3460 sqft garden oasis  
with panoramic views, luxurious  
interiors & numerous meditative  
retreats.  
**\$1,795,000**

## ORINDA



**8 Moraga Court**  
Single level 5 bed/ 4 bath  
home with pool & expansive  
grounds. First time on market  
in over 34 years!  
**\$1,995,000**

## ORINDA



**48 Oak Drive**  
Elegant 4 bed/ 3.5 bath two  
level renovated home with  
remarkable views from terrace  
decks.  
**\$2,495,000**

## ORINDA



Sold

**13 Gardiner Court**  
Custom craftsman home. 6 bed/  
4.5 bath with spectacular views,  
flat play areas, & stunning  
infinity pool.  
**\$3,595,000**

## ORINDA



**57 Charles Hill Circle**  
A new SpringHill Homes mas-  
terpiece! 5 bed/ 4 baths +2 half  
baths with an open floor plan on a  
.75 acre lot.  
**\$4,395,000**

## MORAGA

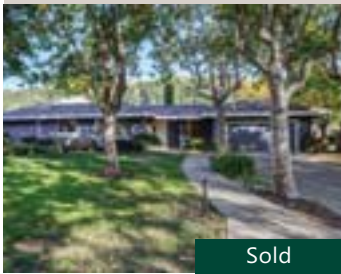

Sold

**806 Augusta Drive**  
Updated single level 3 bed/ 2  
bath home on Moraga Coun-  
try Club golf course. Close to  
schools & trails.  
**\$1,200,000**

## LAFAYETTE



Pending

**1010 Woodbury Road #202**  
3 bed/ 3 bath desirable end  
unit, best location w/ 2 car gar-  
age. Secure access building &  
elevator w/ private entry.  
**\$2,300,000**

## BERKELEY



Lease

**7164 Buckingham Boulevard**  
Fabulous, furnished, light-filled  
3 bed/ 3 bath home. Easy access  
to Hwy 24, UC Berkeley, and the  
Caledcot Tunnel. **\$7,500/ mo**

## PLEASANT HILL

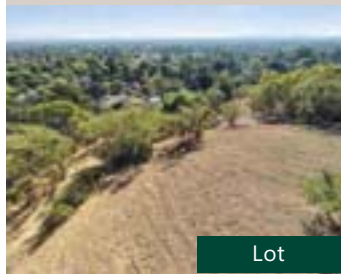

Lot

**20 Whitfield Court**  
Great parcel at top of knoll with  
views of Mt. Diablo. Ideal for  
privacy. Investment opprtunity!  
**\$1,375,000**

## WALNUT CREEK



Sold

**1341 Leisure Lane #4**  
Beautifully updated, sought  
after level-in Yosemite model, 2  
bed/ 1.5 bath. Perfect for  
privacy. Views!  
**\$499,000**

## WALNUT CREEK

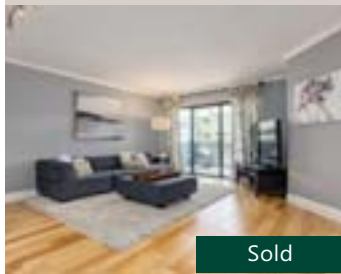

Sold

**1670 San Miguel**  
Spacious 2 bed/ 2.5 condo w/  
remodeled kitchen, hardwood  
floors, & oversized master w/  
large closet. **\$699,000**

## The Village Associates:

Ashley Battersby  
Patricia Battersby  
Shannon Conner  
Meara Dunsmore

Linda Ehrich  
Emily Estrada

Joan Evans  
Linda Friedman  
Claudia Gohler  
Dexter Honens II

Erika Hood Kossut  
Susan Layng

April Matthews  
Hillary Murphy  
Karen Murphy

John Nash  
Altie Schmitt

Judy Schoenrock  
Ann Sharf

Amy Rose Smith  
Molly Smith  
Jeff Snell

Lynda Snell  
Steve Stahle

Clark Thompson  
Angie Evans Traxinger

Ignacio Vega  
Ann Ward

Jenny Lyons Wilhite  
Margaret Zucker

Village

ASSOCIATES

It's Village. Of Course.

DRE#01301392

facebook.com/VillageAssociates  
twitter.com/villageassoc  
instagram.com/VillageAssociates

93 Moraga Way, Suite 103 • Orinda, CA 94563 • Phone: (925) 254-0505

Visit [www.villageassociates.com](http://www.villageassociates.com) Click on [Sunday Open Homes](#)

