

# LAMORINDA'S LEADING INDEPENDENT REAL ESTATE FIRM

## ORINDA



**160/162 Camino Don Miguel**  
6 bd/6.5 ba Spanish Revival estate w/ views of OCC golf course and hills beyond. Exceptional location!

**\$6,395,000**

## ORINDA



**499 Miner Road**  
Set in Sleepy Hollow, this updated 3 bd/ 2.5 ba home w/ walls of windows, soaring ceilings & fabulous floor plan!

**\$1,899,000**

## ORINDA

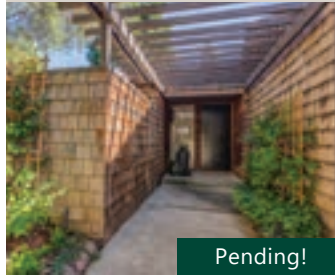

**120 Ravenhill Road**  
Completely renovated 3 bd/ 3 ba Orindawoods home offers an ideal setting w/ natural light, privacy & views!

**\$1,749,000**

## ORINDA



**2 Orchard Court**  
Home sweet home! 3 bd/ 2 ba home needs lots of TLC now & is awaiting the next generation!

**\$999,000**

## ORINDA

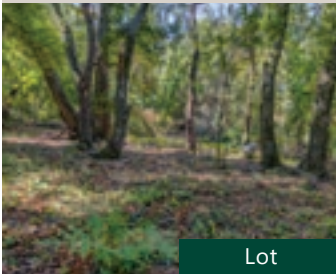

**0 Camino Del Monte**  
Come see this desirable lot located minutes from Hwy 24/BART, top rated schools, downtown, regional parks & views!

**\$225,000**

## ORINDA

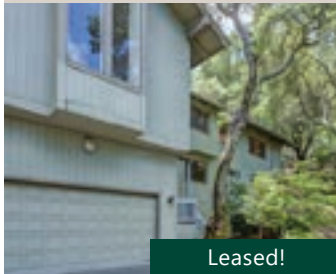

**19 Woodcrest Road**  
Fabulous Glorietta location! Spacious, light & bright 4 bd/ 2.5 ba home with high ceilings and beautiful views!

**\$5,800/mo.**

## LAFAYETTE



**1336 San Reliez Court**  
Rare opportunity on .75 acre lot with 5 bd/ 3.5 ba 4098 sq.ft. in the heart of Springhill!

**\$1,950,000**

## LAFAYETTE



**4010 Woodside Court**  
Spacious 4 bd/ 3 ba home w/ sparkling pool, formal living room & hardwood floors. Private location w/ big views!

**\$5,900/mo.**

## MORAGA

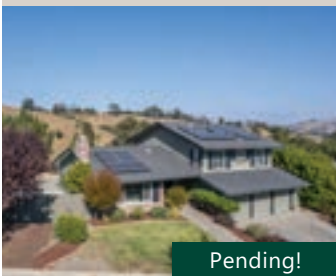

**92 Warfield Drive**  
Classic two story 5 bd/ 3 ba home sits on a private .39 acre parcel w/ 2527 sq.ft of a fully functional floor plan!

**\$1,945,000**

## BERKELEY



**7164 Buckingham Blvd**  
Sophisticated contemporary 3 bd/ 3 ba set in the Claremont Hills featuring lovely canyon views!

**\$1,775,000**

## ALAMEDA



**2114 Buena Vista**  
Permitted duplex on 4,500 sq. ft. lot in Central Alameda! Unit A - 2bd/ 1 ba, w/ formal dining room. Unit B - 1 bd/ 1 ba, w/ lg living space!

**\$895,000**

## DANVILLE

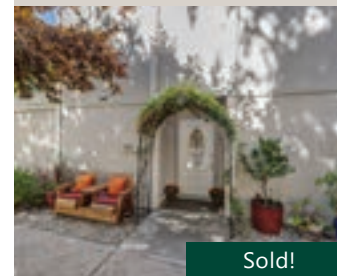

**501 Garden Creek Place**  
Updated 3 bd/ 2.5 ba end-unit townhome less than .5 miles from top-rated schools, downtown & more!

**\$849,900**

## The Village Associates:

Ashley Battersby  
Patricia Battersby  
Shannon Conner  
Meara Dunsmore

Linda Ehrich  
Emily Estrada

Joan Evans

Linda Friedman

Liz Gallagher

Claudia Gohler

Ari Hatton

Gillian Judge Hogan

Dexter Honens II

Christina Linezo

April Matthews

Hillary Murphy

Karen Murphy

John Nash

Altie Schmitt

Judy Schoenrock

Ann Sharf

Amy Rose Smith

Molly Smith

Jeff Snell

Lynda Snell

Alexis Thompson

Clark Thompson

Angie Evans Traxinger

Ignacio Vega

Ann Ward

Margaret Zucker

**Village**

ASSOCIATES

It's Village. Of Course.

DRE#01301392

facebook.com/VillageAssociates  
twitter.com/villageassoc  
instagram.com/VillageAssociates

93 Moraga Way, Suite 103 • Orinda, CA 94563 • Phone: (925) 254-0505

Visit [www.villageassociates.com](http://www.villageassociates.com)

Sunday Open Homes

